



5 ~ 6W AC-DC Single Output Wall-mounted type

GS06U series



■ Features :

- Universal AC input / Full range
- No load power consumption <0.3W
- ErP step2 compliant
- Meet EISA 2007 (Energy Independence and Security Act)
- 2 pole USA plug
- Class II power (without earth pin)
- Protections: Short circuit / Overload / Over voltage
- Pass LPS
- Fully enclosed plastic case
- Approvals: UL / CUL / CB / FCC / CE
- 2 years warranty



SPECIFICATION

| ORDER NO. | GS06U-1P1J | GS06U-11P1J | GS06U-2P1J | GS06U-3P1J | GS06U-4P1J | GS06U-5P1J | GS06U-6P1J | GS06U-8P1J | |
|---------------------------|--|--|-------------|------------|------------|------------|------------|------------|------------|
| OUTPUT | SAFETY MODEL NO. | GPSU06U-1 | GPSU06U-1-1 | GPSU06U-2 | GPSU06U-3 | GPSU06U-4 | GPSU06U-5 | GPSU06U-6 | GPSU06U-8 |
| | DC VOLTAGE Note.2 | 5V | 7.5V | 9V | 12V | 15V | 18V | 24V | 48V |
| | RATED CURRENT | 1.00A | 0.8A | 0.66A | 0.5A | 0.4A | 0.33A | 0.25A | 0.125A |
| | CURRENT RANGE | 0 ~ 1.00A | 0 ~ 0.8A | 0 ~ 0.66A | 0 ~ 0.5A | 0 ~ 0.4A | 0 ~ 0.33A | 0 ~ 0.25A | 0 ~ 0.125A |
| | RATED POWER | 5W | 6W | 6W | 6W | 6W | 6W | 6W | 6W |
| | RIPPLE & NOISE (max.) Note.3 | 50mVp-p | 80mVp-p | 80mVp-p | 100mVp-p | 120mVp-p | 150mVp-p | 180mVp-p | 200mVp-p |
| | VOLTAGE ADJ. RANGE | Fixed | | | | | | | |
| | VOLTAGE TOLERANCE Note.4 | ±5.0% | ±5.0% | ±5.0% | ±3.0% | ±3.0% | ±3.0% | ±2.0% | ±2.0% |
| | LINE REGULATION Note.5 | ±0.5% | ±0.5% | ±0.5% | ±0.5% | ±0.5% | ±0.5% | ±0.5% | ±0.5% |
| | LOAD REGULATION Note.6 | ±5.0% | ±5.0% | ±5.0% | ±3.0% | ±3.0% | ±3.0% | ±2.0% | ±2.0% |
| SETUP, RISE, HOLD UP TIME | 1000ms, 50ms, 12ms at full load | | | | | | | | |
| INPUT | VOLTAGE RANGE | 90 ~ 264VAC 127 ~ 370VDC | | | | | | | |
| | FREQUENCY RANGE | 47 ~ 63Hz | | | | | | | |
| | EFFICIENCY (Typ.) Note.7 | 68% | 74% | 75% | 77% | 78% | 78% | 82% | 84% |
| | AC CURRENT | 0.2A / 100VAC | | | | | | | |
| | INRUSH CURRENT (max.) | 50A / 230VAC | | | | | | | |
| LEAKAGE CURRENT(max.) | 0.25mA / 240VAC | | | | | | | | |
| PROTECTION | OVERLOAD | >105% rated output voltage power for 5V ; >110% rated output power for 7.5 ~ 48V Protection type : Hiccup mode, recovers automatically after fault condition is removed | | | | | | | |
| | OVER VOLTAGE | >120% rated output voltage Protection type : Clamp by zener diode | | | | | | | |
| ENVIRONMENT | WORKING TEMP. | 0 ~ +40°C (Refer to "Derating Curve") | | | | | | | |
| | WORKING HUMIDITY | 20% ~ 90% RH non-condensing | | | | | | | |
| | STORAGE TEMP., HUMIDITY | -20 ~ +85°C, 10 ~ 95% RH | | | | | | | |
| | TEMP. COEFFICIENT | ±0.03% / °C (0 ~ 50°C) | | | | | | | |
| | VIBRATION | 10 ~ 500Hz, 2G 10min./1cycle, period for 60min. each along X, Y, Z axes | | | | | | | |
| SAFETY & EMC (Note. 8) | SAFETY STANDARDS | UL60950-1, CSA22.2 approved | | | | | | | |
| | WITHSTAND VOLTAGE | I/P-O/P:4242VDC | | | | | | | |
| | ISOLATION RESISTANCE | I/P-O/P:100M Ohms / 500VDC / 25°C / 70% RH | | | | | | | |
| | EMC EMISSION | Compliance to EN55022, EN61000-3-2,3, FCC part 15 Class B | | | | | | | |
| OTHERS | EMC IMMUNITY | Compliance to EN61000-4-2,3,4,5,6,11, light industry level, criteria A | | | | | | | |
| | MTBF | 500Khrs min. MIL-HDBK-217F(25°C) | | | | | | | |
| CONNECTOR | DIMENSION | 32*66*42.5mm (L*W*H) | | | | | | | |
| | PACKING | 100g ; 110pcs / 12Kg / CARTON | | | | | | | |
| CONNECTOR | PLUG | Standard type P1J: 2.1φ * 5.5φ * 11mm, turning fork type center positive for stock ; Other type available by customer requested | | | | | | | |
| | CABLE | Standard type 20Awg UL1185 6ft for stock ; Other type available by customer requested | | | | | | | |
| NOTE | <ol style="list-style-type: none"> 1.All parameters are specified at 115VAC input, rated load, 25°C 70% RH ambient. 2.DC voltage: The output voltage set at point measure by plug terminal & 50% load. 3.Ripple & noise are measured at 20MHz by using a 12" twisted pair terminated with a 0.1uf & 47uf capacitor. 4.Tolerance: includes set up tolerance, line regulation, load regulation. 5.Line regulation is measured from low line to high line at rated load. 6.Load regulation is measured from 0% to 100% rated load 7.Efficiency is measured at 115VAC. 8.The power supply is considered as an independent unit, but the final equipment still need to re-confirm that the whole system complies with the EMC directives. | | | | | | | | |

■ Mechanical Specification

Unit:mm

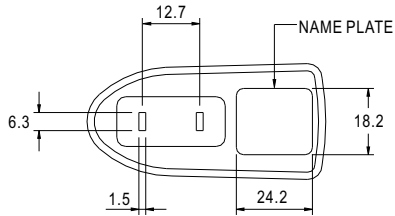

■ Plug Assignment

Standard plug: P1J

| P1J | |
|--------|--------|
| P/N | OUTPUT |
| CENTER | + |

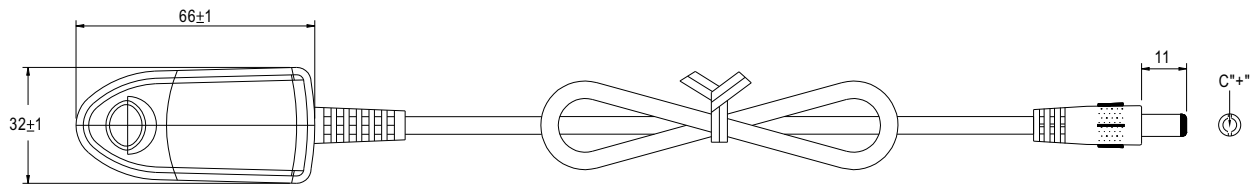
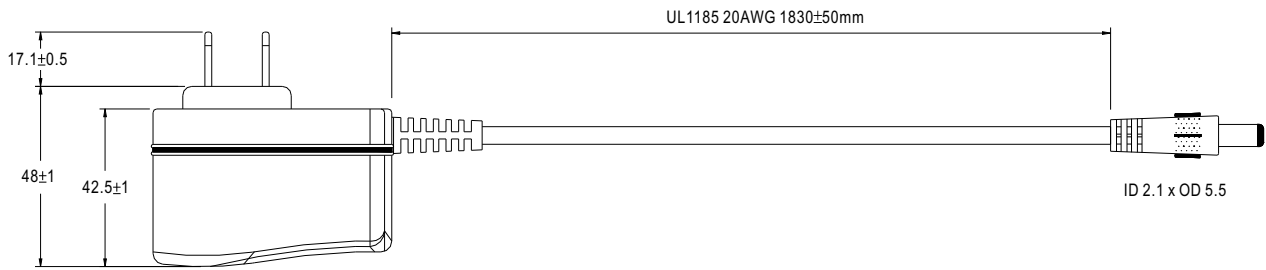

■ Derating Curve

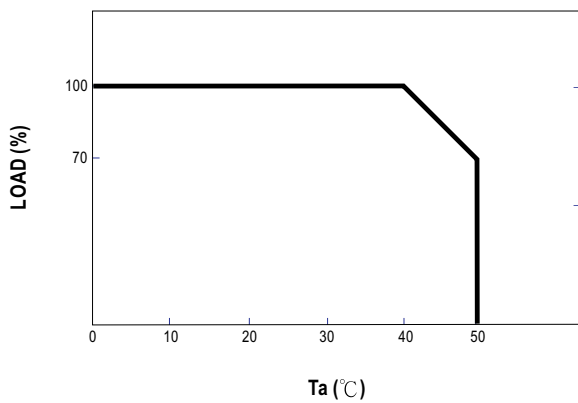

■ Static Characteristics

